

## Remote Patient Monitoring Made Easy

Introducing an important service allowing you to stay connected with your health care team from home - 24 hours a day, 7 days a week. The RevUp Care Hub is ordered by your doctor and provides additional peace of mind for you and your family.

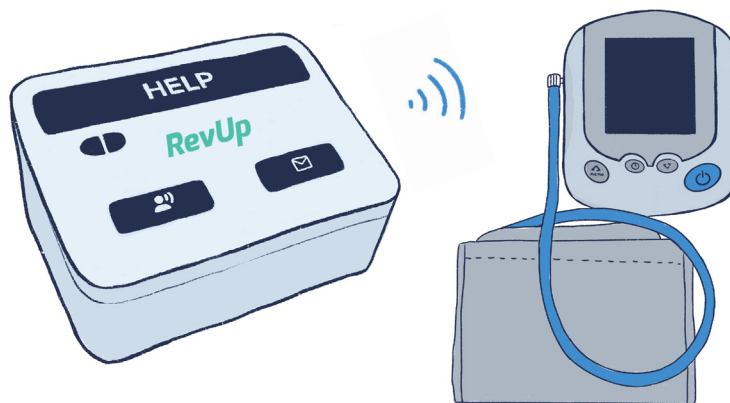

Our care team will call you to help set up your new RevUp Care Hub and your devices - it's easy!

To enroll, call: (866) 369-7100

### Health Management



Your new RevUp Care Hub makes managing your health at home effortless. Using the health devices your doctor has provided for you, important information regarding your vitals is uploaded and stored automatically in your RevUp app and health dashboard, and is also made available to your doctor to view the information they need the most to stay on top of your health.

### Remote Monitoring



Remote vitals monitoring with the RevUp Care Hub provides alerts to your clinical care team when your vitals are outside of their pre-determined thresholds, providing an opportunity for quick intervention and immediate care. We believe this will lead to better health outcomes and recovery times related to your medical conditions.

## Care Reminders



The RevUp Care Hub is programmed to match your individual care plan and will electronically remind you take medications, follow through on treatment tests such as blood pressure, blood sugar or important recurring appointments. If you do not respond to these reminders, this will trigger an alert to our clinical care team, who will attempt to reach you directly for a wellness check.

## Emergency Response Service

In an emergency, just press the button on your watch pendant or RevUp Care Hub and you will be connected to an emergency response team who will stay on the line and get help.

## Nurse Connect

Your RevUp Care Hub easily connects you to a health coach working with your doctor if you have questions or need support.

